

FRED T. STIMPSON SPECIAL OPPORTUNITY AREA

ALABAMA DEPARTMENT OF CONSERVATION
AND NATURAL RESOURCES

DIVISION OF WILDLIFE
AND FRESHWATER FISHERIES

A WILDLIFE RESTORATION PROJECT

*This map must
be signed admitting you understand
and agree to abide by all laws and regulations
and be in your possession to be valid.*

HUNT COMPARTMENTS

- ZONE 1**
Mixed mature timber with ridges, hills, creek bottoms and wildlife openings.
- ZONE 2**
Mixed mature timber with ridges, deep bottoms, abundant open ground and planted food plots.
- ZONE 3**
Mixed mature timber with ridges, steep slopes and a large creek bottom.
- ZONE 4**
Mixed timber with a planted food plot, creek bottom and steep slopes.
- ZONE 5**
Mixed timber, large openings, some creek bottom & steep slopes.
- ZONE 6**
Mixed timber, some openings, food plot, creek bottom, upland, some steep slopes.
- ZONE 7**
A lot of creek bottom, some steep hills, large opening next to creek.
- ZONE 8**
Some creek bottom, hills with mixed timber, some pine stands, one large opening.
- ZONE 9**
Mostly pine timber, a food plot & opening, some hardwood in drains, some hills.
- ZONE 10**
Some open clearcut areas & mixed timber, pine plantations, one large food plot, several openings, creek bottom.
- ZONE 11**
Mostly open pine timber and thick plantations, some mixed hardwood timber in drains, a couple of openings.
- ZONE 12**
Partially clearcut pine stand with some mixed hardwood timber in drains, some hills, mostly flat.
- ZONE 13**
Mixed timber, some ridges, some steep slopes, a couple of food plots, creek bottom, river flood plain.
- ZONE 14**
Mixed timber, some upland, ridges, creek bottom, river flood plain, large openings, food plots.
- ZONE 15**
Mixed timber in upland, large food plots, some steep hills, creek bottom.

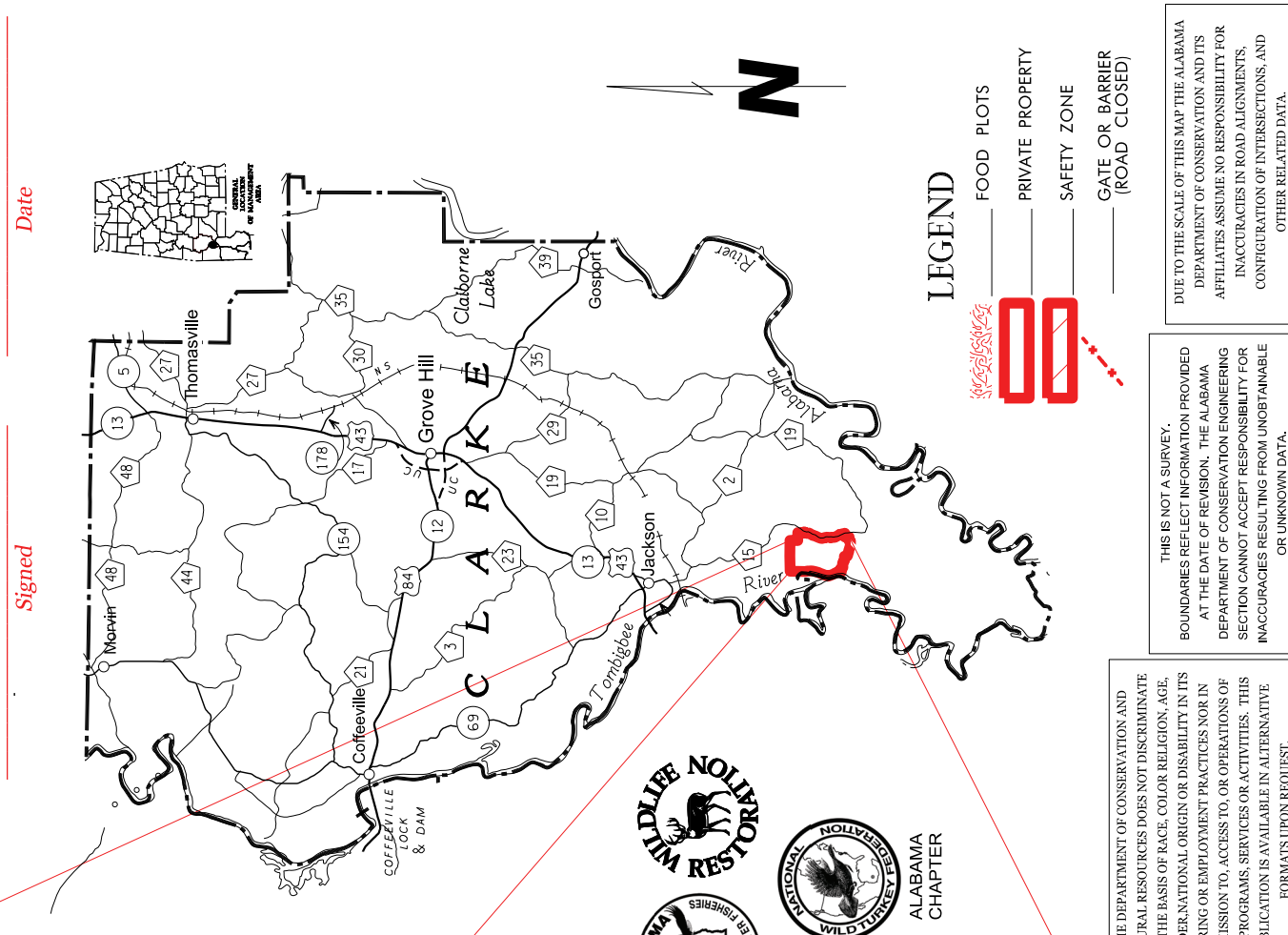
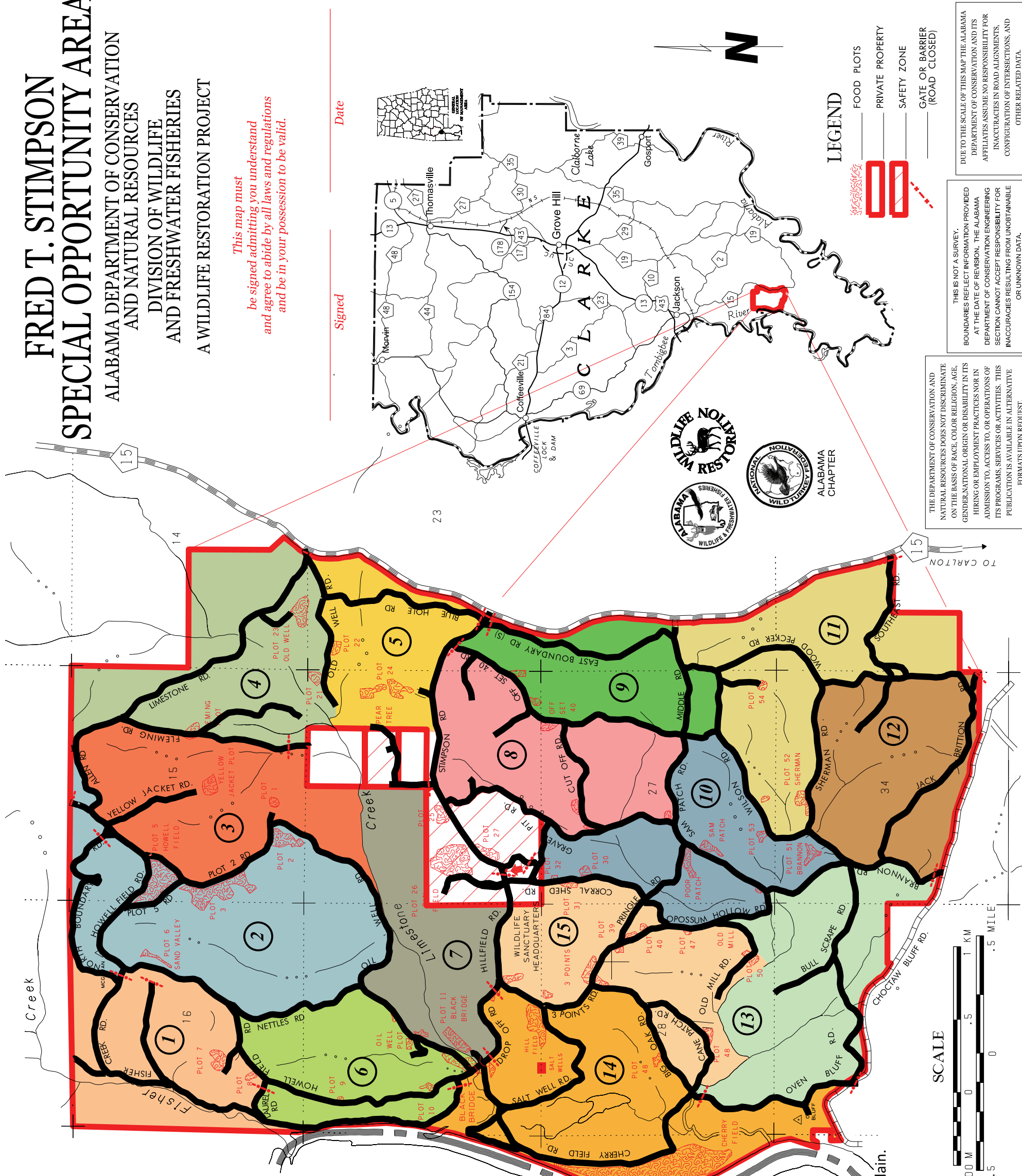

THE DEPARTMENT OF CONSERVATION AND NATURAL RESOURCES DOES NOT DISCRIMINATE ON THE BASIS OF RACE, COLOR RELIGION, AGE, GENDER, NATIONAL ORIGIN OR DISABILITY IN ITS HIRING OR EMPLOYMENT PRACTICES NOR IN ADMISSION TO, ACCESS TO, OR OPERATIONS OF ITS PROGRAMS, SERVICES OR ACTIVITIES. THIS PUBLICATION IS AVAILABLE IN ALTERNATIVE FORMATS UPON REQUEST.

THIS IS NOT A SURVEY. BOUNDARIES REFLECT INFORMATION PROVIDED AT THE DATE OF REVISION. THE ALABAMA DEPARTMENT OF CONSERVATION ENGINEERING SECTION CANNOT ACCEPT RESPONSIBILITY FOR INACCURACIES RESULTING FROM UNOBTAINABLE OR UNKNOWN DATA.

DUE TO THE SCALE OF THIS MAP THE ALABAMA DEPARTMENT OF CONSERVATION AND ITS AFFILIATES ASSUME NO RESPONSIBILITY FOR INACCURACIES IN ROAD ALIGNMENTS, CONFIGURATION OF INTERSECTIONS, AND OTHER RELATED DATA.